

**NOTES:**

1. THE CONTRACTOR SHALL FIELD ADJUST LOCATIONS AND SPACING AS NECESSARY TO ACCOMMODATE FIELD CONDITIONS.
2. EXISTING SIGNS THAT CONFLICT WITH THE SIGNAGE SHOWN ON THIS PLAN SHEET SHALL BE COVERED UNLESS OTHERWISE SHOWN.
3. SIGN SPACING SHALL MEET THE MINIMUM SPACING REQUIREMENTS OF THE MUTCD AND UDOT STD DWGS.

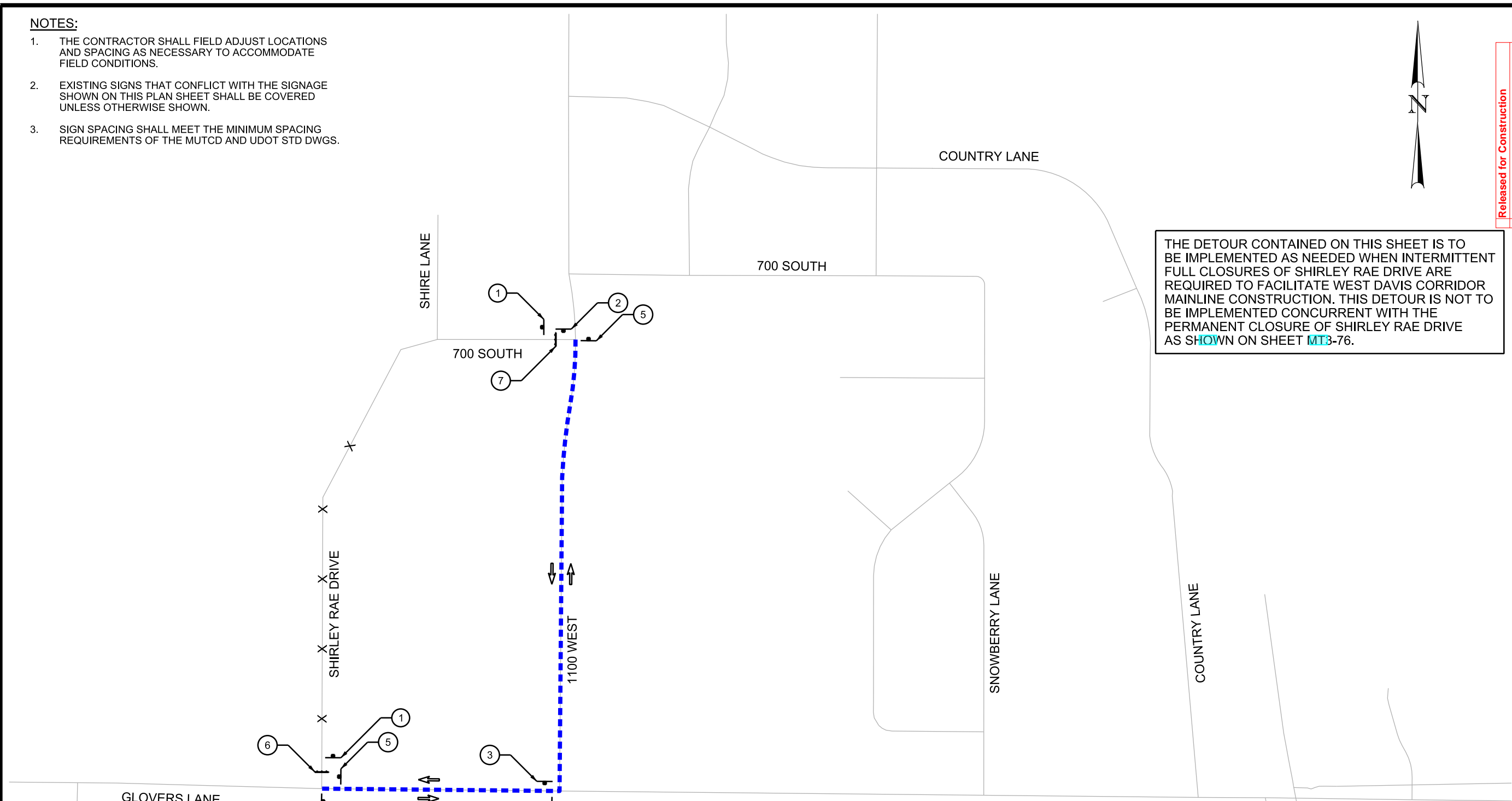

Released for Construction



THE DETOUR CONTAINED ON THIS SHEET IS TO BE IMPLEMENTED AS NEEDED WHEN INTERMITTENT FULL CLOSURES OF SHIRLEY RAE DRIVE ARE REQUIRED TO FACILITATE WEST DAVIS CORRIDOR MAINLINE CONSTRUCTION. THIS DETOUR IS NOT TO BE IMPLEMENTED CONCURRENT WITH THE PERMANENT CLOSURE OF SHIRLEY RAE DRIVE AS SHOWN ON SHEET MT3-76.

① INSTALL PORTABLE CMS 6 DAYS PRIOR TO CLOSURE. PORTABLE CMS MESSAGE TO BE DEVELOPED THROUGH THE CLOSURE REQUEST PROCESS. PORTABLE CMS TO BE REMOVED UPON IMPLEMENTATION OF DETOUR.

② SHIRLEY RAE DR CUSTOM 6 IN LETTER SIZE M4-9 (T) 30 IN X 24 IN  
 ③ SHIRLEY RAE DR CUSTOM 6 IN LETTER SIZE M4-9 (R) 30 IN X 24 IN

④ SHIRLEY RAE DR CUSTOM 6 IN LETTER SIZE M4-9 (L) 30 IN X 24 IN  
 ⑤ END DETOUR M4-8a 24 IN X 18 IN

⑥ ROAD CLOSED TO THRU TRAFFIC  
 DETOUR → M4-10 (R) 48 IN X 18 IN  
 R11-4 60 IN X 30 IN MOUNTED ON TYPE 3 BARRICADE (R)

⑦ ROAD CLOSED TO THRU TRAFFIC  
 ← DETOUR M4-10 (L) 48 IN X 18 IN  
 R11-4 60 IN X 30 IN MOUNTED ON TYPE 3 BARRICADE (L)

**LEGEND**

- TRAFFIC FLOW ARROWS
- CLOSURE
- TEMPORARY SIGN
- DETOUR ROUTE
- TYPE 3 BARRICADE

<b>UTAH DEPARTMENT OF TRANSPORTATION</b>									
PROJECT: SR-177, WEST DAVIS HWY; I-15 & SR-67 TO SR-193 PROJECT NUMBER: SR-199(229)	PIN: 11268 APPROVED: CHECKED BY: BDB DATE: 01/14/22								
<b>SHIRLEY RAE DRIVE DETOUR LAYOUT</b>									
SHEET NO. DT3-29	REVISIONS: <table border="1" style="width: 100%; border-collapse: collapse;"> <tr> <th>NO.</th> <th>DATE</th> <th>APPROVED BY</th> <th>REMARKS</th> </tr> <tr> <td>0</td> <td>01/14/22</td> <td>BDB</td> <td>RFC - MOT - 3</td> </tr> </table>	NO.	DATE	APPROVED BY	REMARKS	0	01/14/22	BDB	RFC - MOT - 3
NO.	DATE	APPROVED BY	REMARKS						
0	01/14/22	BDB	RFC - MOT - 3						

12/22/2021 p:\p\m\chm\ts\org\Design\Build\Documents\Northwest\Division\65798\001\West Davis Corridor\12 Design Postward\CADD\Sheets\MOT\MOT-3\11268-ShirleyRaeDr-DeTourLayout.mxd